

OWNER & APPLICANT:

LGW PROPERTIES LLC.
2 VISTA LA.
MONROE, NY 10950

VICINITY MAP:

SCALE: 1"=200'

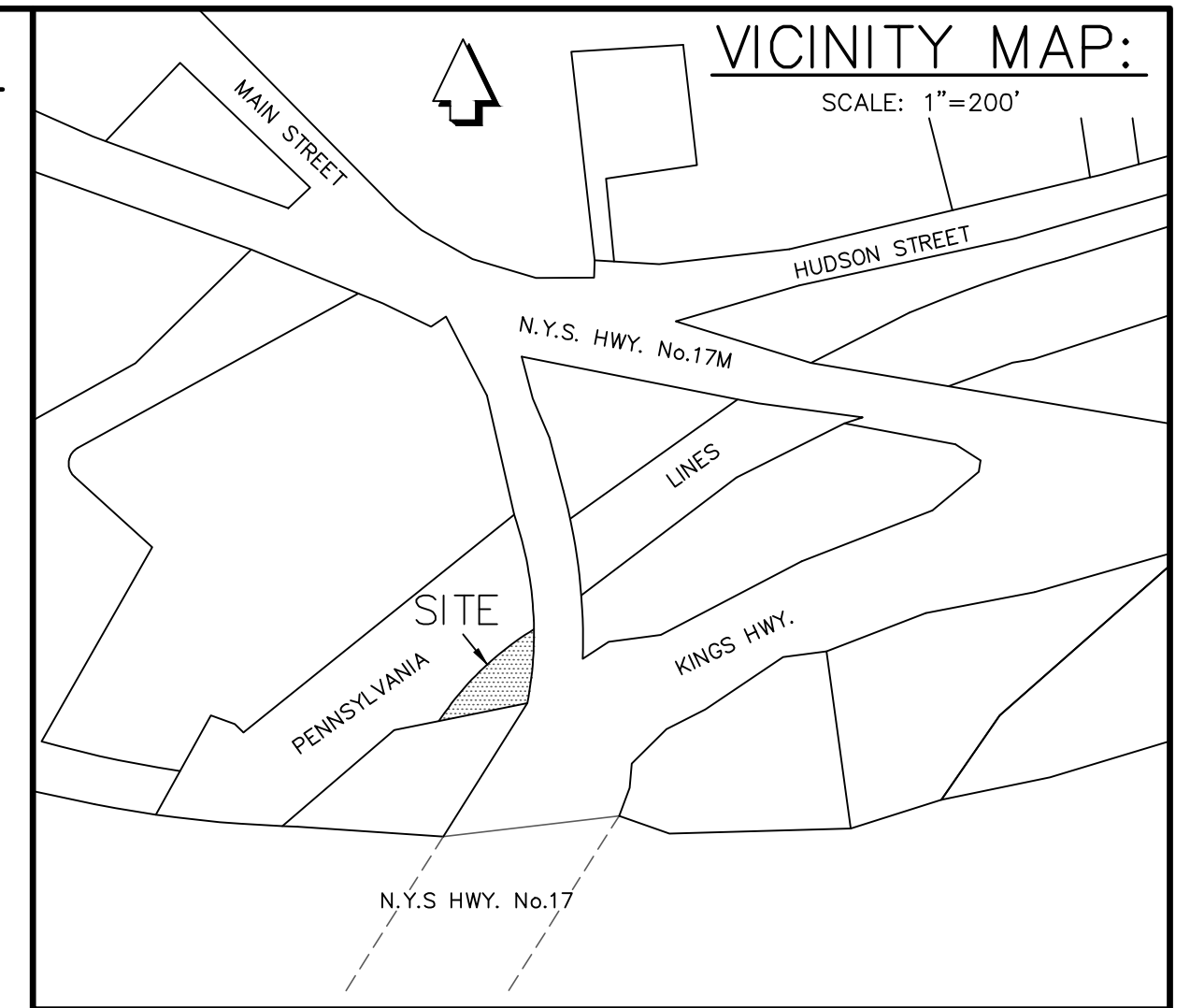

ZONE: M-2 MANUFACTURING

MINIMUM LOT AREA	1 ACRES
MINIMUM LOT WIDTH	150 FT.
MINIMUM FRONT YARD	50 FT.
MINIMUM SIDE YARD	30 FT.
MINIMUM SIDE YARD BOTH	60 FT.
MINIMUM REAR YARD	30 FT.
MAXIMUM BUILDING HEIGHT	40 FT.
MAXIMUM BUILDING STORIES	2 STORIES
MAXIMUM LOT COVERAGE	60%
MINIMUM HABITABLE DWELLING AREA	500 SQ. FT.

PRE-EXISTING USE: FIRST FLOOR - RETAIL, WHOLESALE, STORAGE AND GARAGE (EASTERN TILE)
SECOND FLOOR - 3 BEDROOM APARTMENT.

NOTES:

- TAX MAP DESIGNATION: VILLAGE OF CHESTER SECTION 114 BLOCK 1 LOT 14
- WATER SUPPLY: MUNICIPAL - VILLAGE OF CHESTER
- SEWAGE DISPOSAL: MUNICIPAL - VILLAGE OF CHESTER
- PARKING LICENSE AGREEMENT WITH VILLAGE OF CHESTER.

SITE PLAN FOR

LGW PROPERTIES, LLC.

VILLAGE OF CHESTER
SCALE: 1"=20'

ORANGE COUNTY, N.Y.
AREA=0.1469 ACRES

JUNE 21, 2013

GRAPHIC SCALE



(IN FEET)
1 inch = 20 ft.

HANDICAPPED PARKING DETAIL
(TYPICAL)

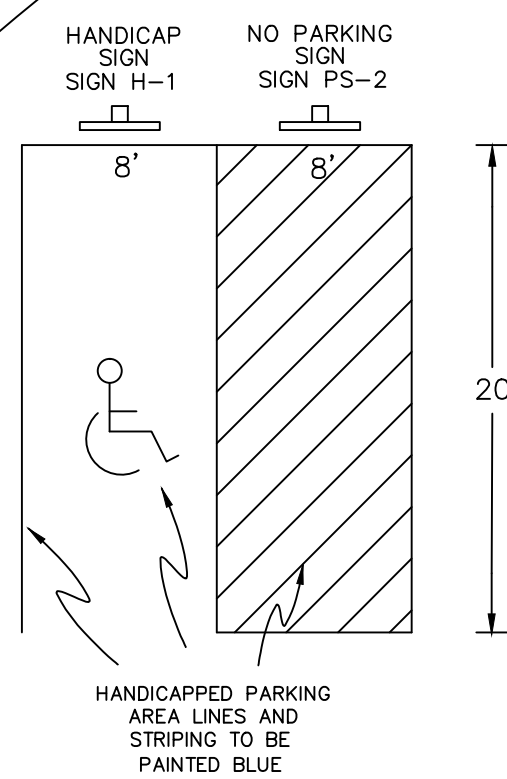

SIGN H-1
SIGN DETAIL
NOTE: SIGN TO BE BLUE
TYPICAL FOR PARKING SPACE

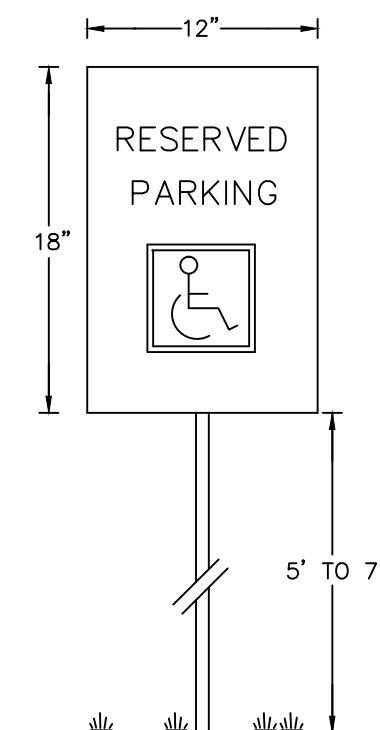

SIGN PS-2
SIGN DETAIL
NOTE: SIGN TO BE BLUE
TYPICAL FOR ACCESS AISLE

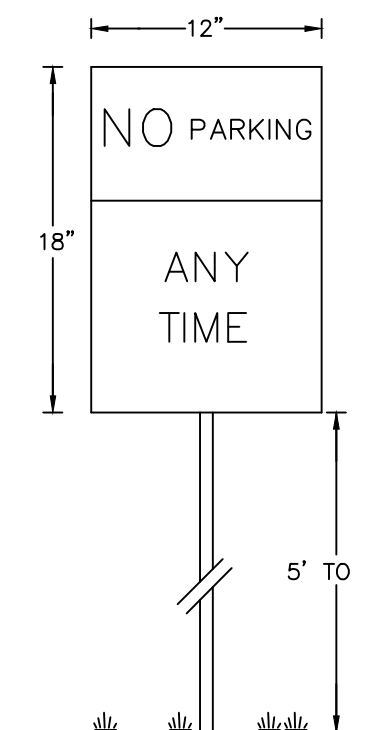

UNAUTHORIZED ALTERATION OF THIS DOCUMENT, IN ANY WAY, CONSTITUTES A VIOLATION OF THE STATE OF NEW YORK EDUCATION LAW SECTION 7209 (2).

OR13-31

STATE OF NEW YORK
JAMES A. DILLIN
LIC. 49087
JAMES A. DILLIN, PLS
PROFESSIONAL LAND SURVEYOR
GOSHEN, NEW YORK